

Product Description

Experience the ultimate in convenience and luxury with our flagship EO23 Electric Opening Skylight. New for 2023, our latest model has been reimagined and received a complete design overhaul.

The new design now features a thermally broken aluminium frame with integrated actuator motor. There are now more ways to control with the solar-powered rain sensor, and WIFI enabled mobile connectivity via the 'Smart Life' application.



Product Specification

Frame Material	3mm commercial-grade aluminium
Frame Colour	Anthracite grey - RAL 7016
Thermal Break	Yes
Concealed Motor Chamber	Yes
Unit Weight	70kg m ²
Thermal Transmittance (U-Value:)	1.3 W/m ² K
Self-Clean Coating (outer-pane):	SmartGuard Self-Clean
Glass Outer Pane:	6mm clear toughened softcoat BS EN 12150 C1
Spacer	16mm warm edge spacer – 90% argon filled BS EN 1279
Glass Inner Pane:	8mm clear laminated toughened EN 14449:2005
Motor	Chain-driven Actuator
Voltage	24V
Receiver	ZC34T-03 (WIFI) AC
Operation Methods	Wireless Remote Control Wall Control Module Solar Powered Rain Sensor
App Connectivity	Compitabily with 'Smart Life' application, which supports voice control connectivity such as Alexa.

All electrical and wiring work must only be carried out by a qualified electrician. Failure to use a qualified electrician can lead to improper installation, safety risks and building regulation compliance difficulties, e.g. 'Electrical safety: Approved Document P'. It will also void our electrical components warranty.

Safety Warning: Danger of crushing due to automated closing mechanism. Do not carry out work or maintenance on or near the skylight without disconnecting mains power with skylight in closed position.

Skylight not rated for human foot traffic, i.e. walking on the unit. You must take proper precautions to prevent/warn others from doing so.

Warranty Information All units must be handled, stored, and fixed in accordance with our installation drawings. Any claim must be accompanied by a copy of the original purchase invoice. This warranty covers replacement of parts only. This warranty is non-transferable. Glazing (sealed unit) warranty cover: 20 years Electrical component warranty cover: 1 year.

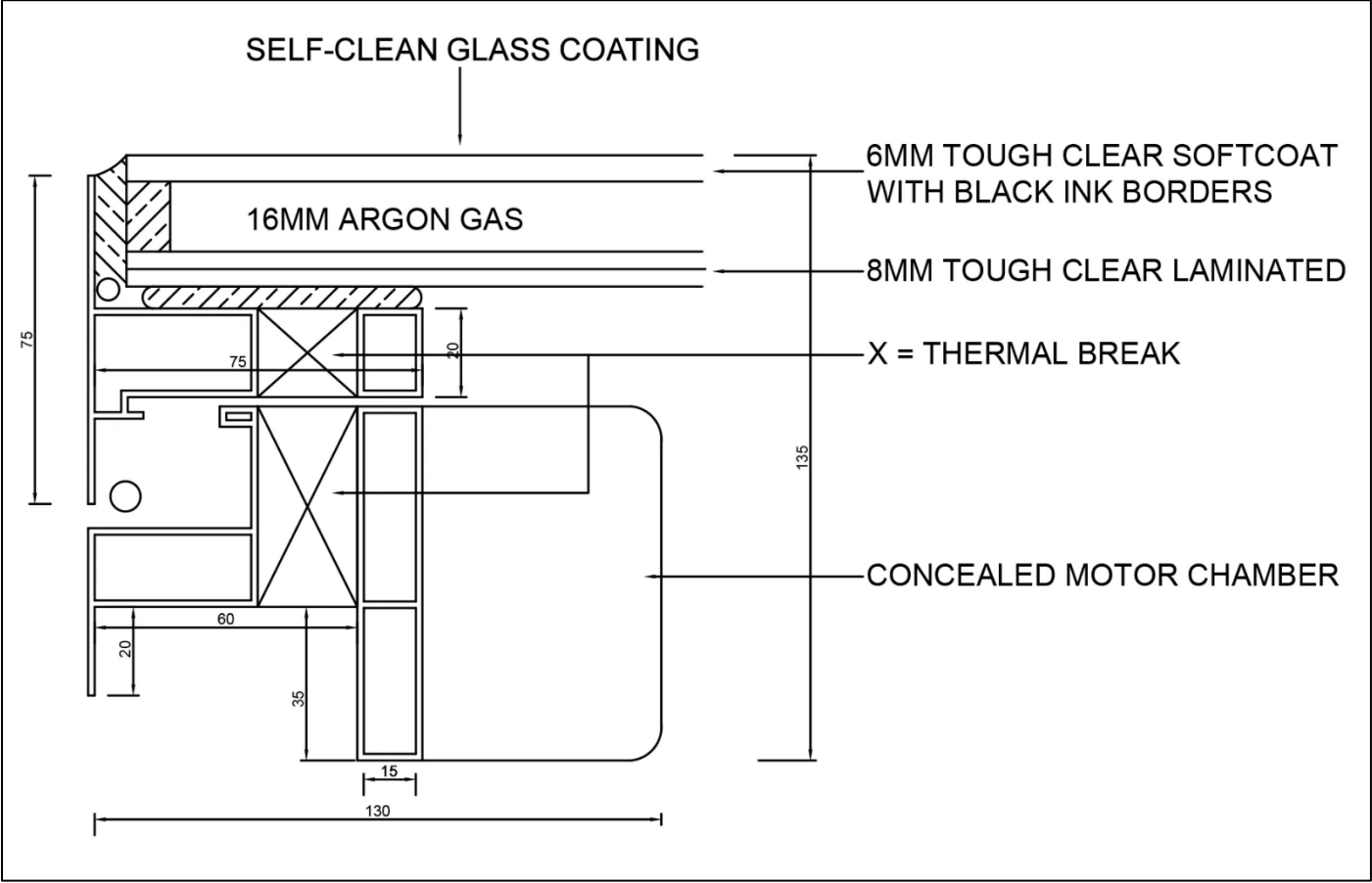

Technical Drawing 1

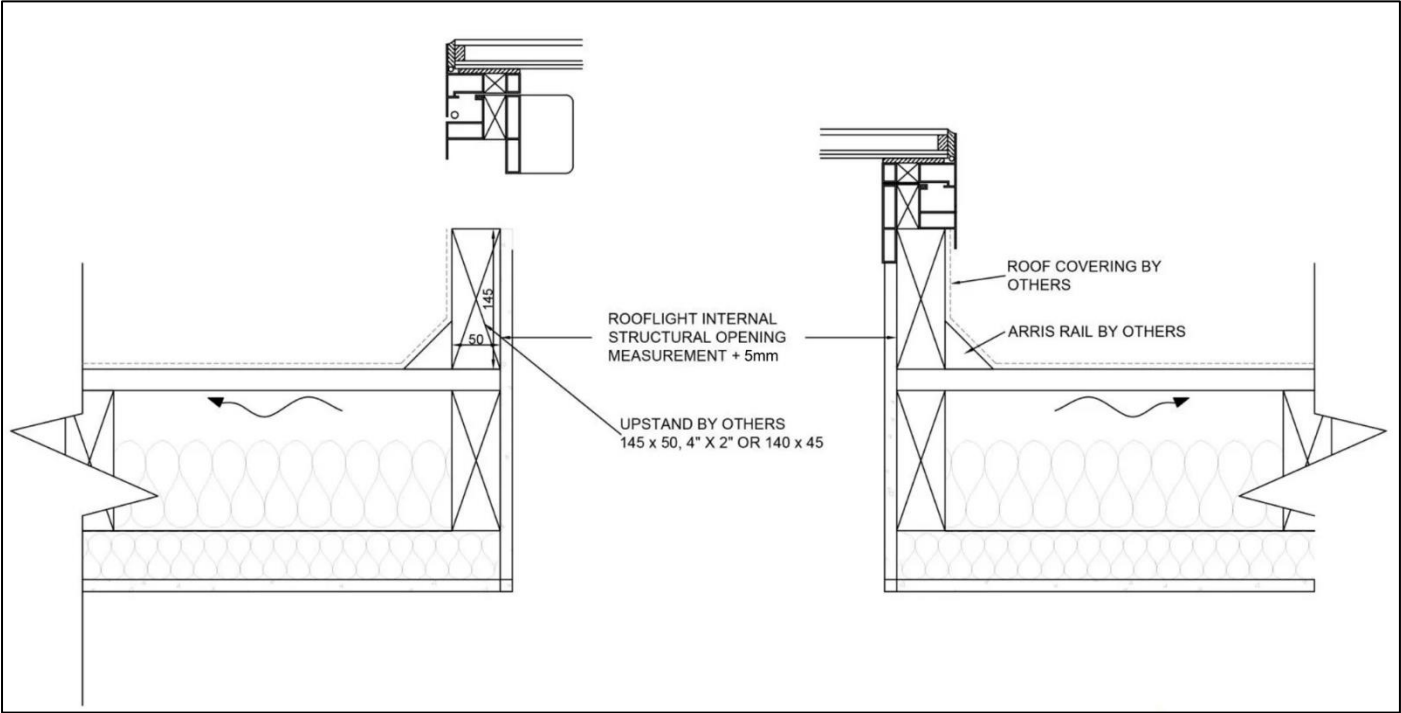

Installation Upstand Detail Drawing 2